

3-way ball valves *3-Wege Kugelventile*

ZV Ø39 mm

- **High wear resistance**
Hohe Verschleißfestigkeit
- **Modified polyamide as sealing**
Modifiziertes Polyamid als Dichtung
- **Ball bearing shaft**
Kugelgelagerte Schaltwelle
- **Exceptionally compact**
Außergewöhnlich kompakt
- **Very short switching time**
Sehr kurze Schaltzeit



Pressure *Druck-*
inflow *eingang*

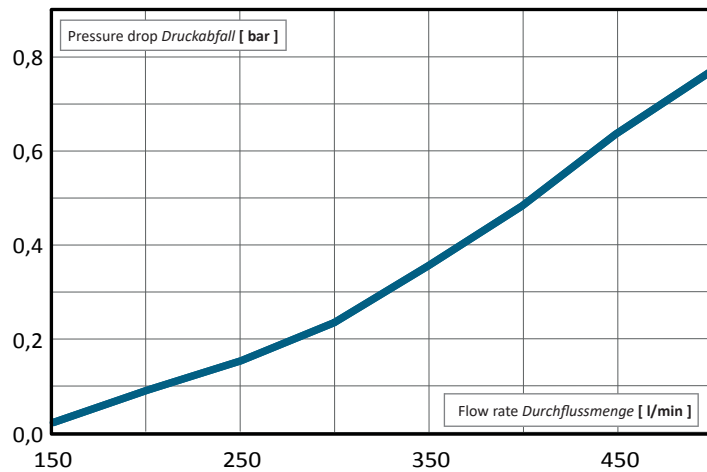

Operating pressure <i>Betriebs-Dauerdruck</i>	Flow rate <i>Durchfluss</i>	Inlet <i>Einlass</i>	Outlets <i>Auslass</i>	Material <i>Material</i>		
				Ball <i>Schaltkugel</i>	Housing <i>Gehäuse</i>	Sealing <i>Dichtung</i>
max. 15 bar	max. 500 l/min	AS50	2 x AS50	Stainless steel <i>Edelstahl</i>	POM GF	PA

Mounting *Befestigung*

Ø 32 mm
Flow cross-section
Strömungsdurchmesser

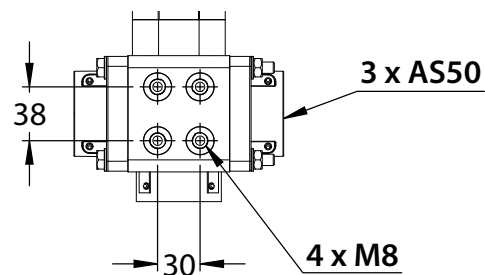

Specifications in mm
Angaben in mm

3-way ball valves 3-Wege Kugelventile

ZV Ø39 mm

Dimensions Abmessungen

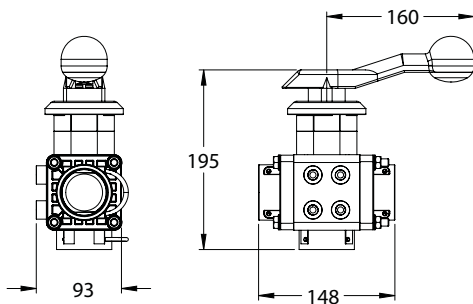
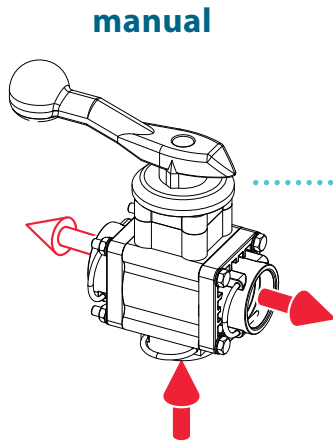

Article no. Artikel-Nr.	ZV Ø39 mm	Drive Antrieb
83163	manual manuell	
83160	electric elektrisch	2-wire 2-Draht
83173	electric elektrisch	3-wire 3-Draht

electric

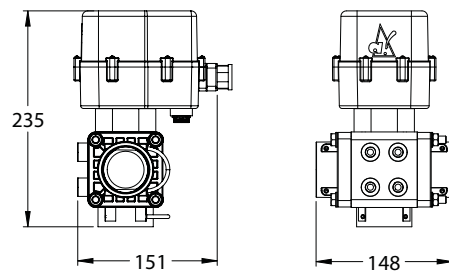
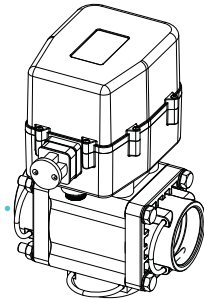

Specifications in mm
Angaben in mm

Drive Ansteuerung

Basic parameters Eigenschaften		
Nominal voltage	Nennspannung	12 V / DC ± 10%
Current input	Stromaufnahme	3,5 A (20 bar)
Switching time	Schaltzeit	450 ms

Automatically shut off in case of:
Automatisches Abschalten bei:

Current consumption
Stromaufnahme

Motor power supply
Motorspannung

> 9 A
< 9,5 V

Cube plug
Würfelstecker

DIN EN 175 301-803-A

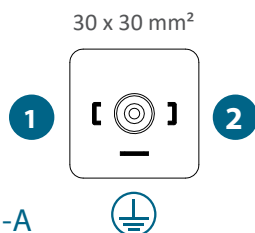

Pin	2-Wire 2-Draht	3-Wire 3-Draht
1	+ 12 V	+ 12 V
2	GND	+ 12 V
	n.c. n. a.	GND

Pole reversal closes the valve.
Umpolung schließt das Ventil.

3-way ball valves 3-Wege Kugelventile
ZV Ø39 mm Fittings

AS50
Fittings 111 ff.

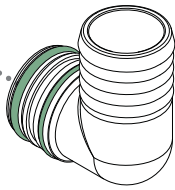
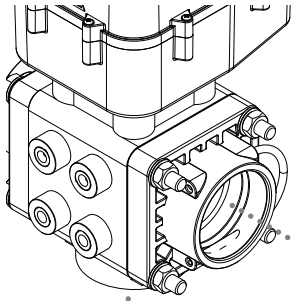

Article no. Male hose tail
Artikel-Nr. Stecktülle

AS50	Article no.	Male hose tail	
	24891	ø 39 mm	┘
	17330	ø 46 mm	┘

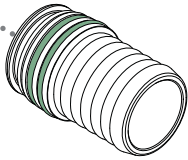

	22040	ø 39 mm	/
	17157	ø 46 mm	/

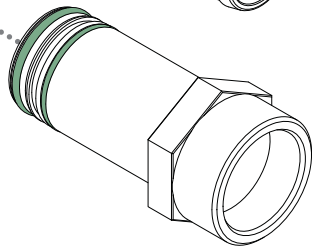

	80610	G2	male
--	-------	----	------

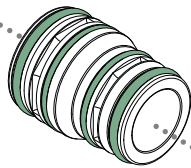

Article no. Adapter AS / AS
Artikel-Nr.

	82945	AS40
--	-------	------

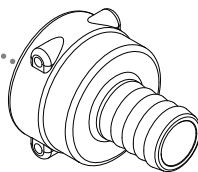

Article no. Female hose tail
Artikel-Nr. Stülptülle

AS40	Article no.	Female hose tail	
	80354	ø 20 mm	/
	80357	ø 25 mm	/
	34232	ø 33 mm	/
	34231	ø 39 mm	/
	83967	ø 40 mm	/

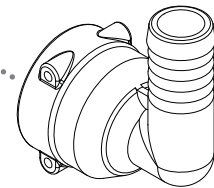

	81655	ø 20 mm	┘
	81654	ø 25 mm	┘
	81653	ø 33 mm	┘
	81652	ø 39 mm	┘

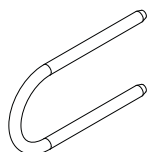

Article no. Safety Pin
Artikel-Nr. Sicherungsstecker

	05241	AS40
--	-------	------